

# LOBBY / Floor 1

Usable Space  
 Column  
 = 4 sq ft

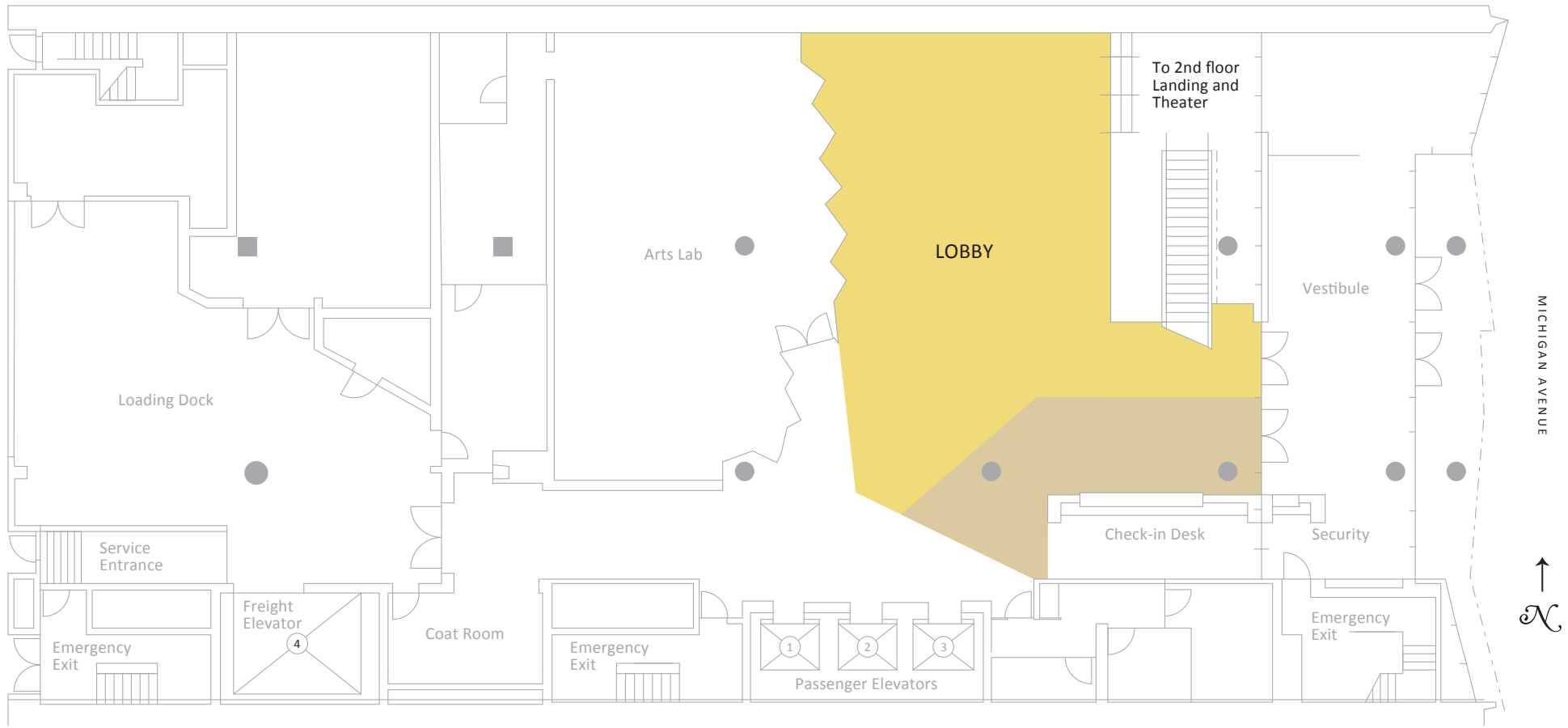

## SPECIFICATIONS

- 2,723 sq ft
- 200 standing reception
- Accommodates vehicles\*
- Bag/Coat Room
- 3 passenger elevators
- 3-story atrium
- F&B permitted
- Loading dock w/freight elevator access
- Wireless internet
- Wired locations (options available up to 1gbps)