

MEETING ROOMS / Floor 3

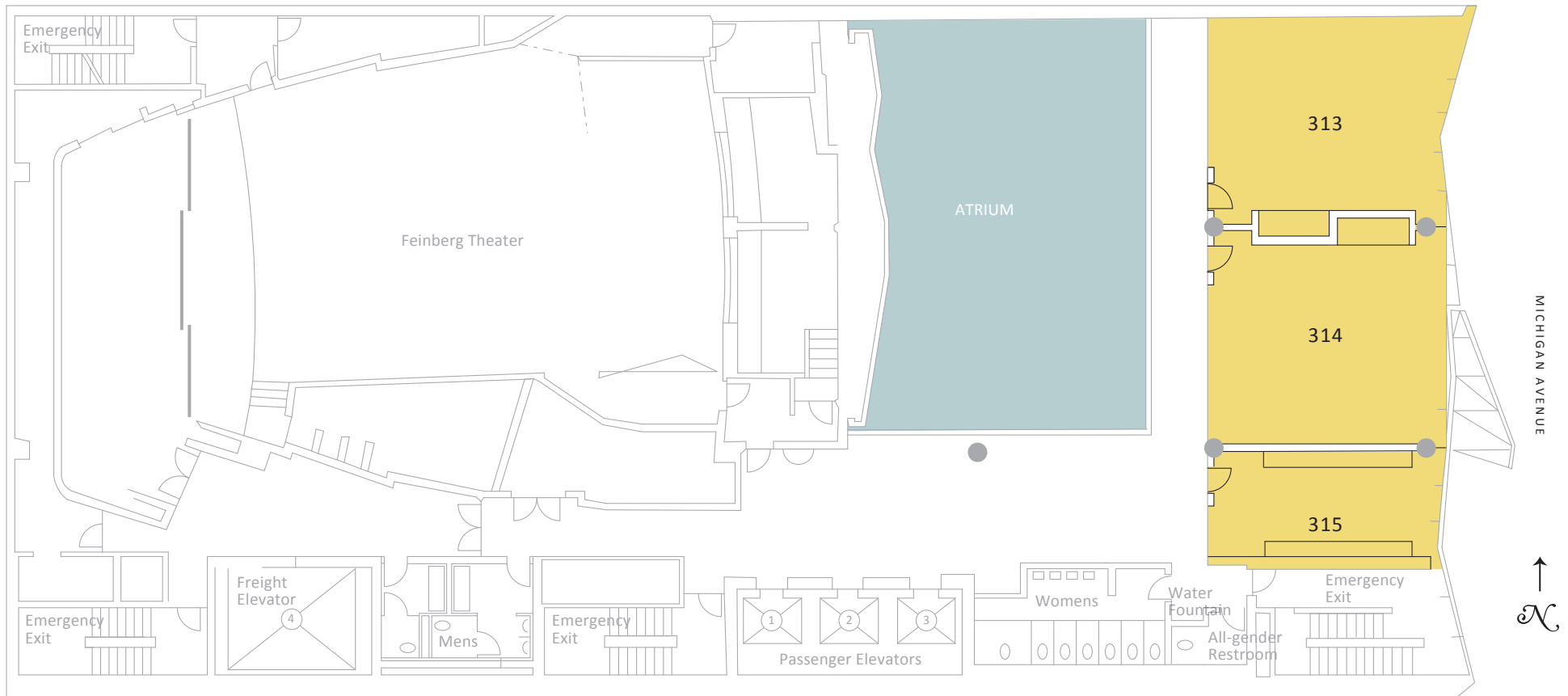

SPECIFICATIONS

All Spaces

- F&B allowed
- Ceiling height 10 ft
- Restrooms
- Wireless internet
- Wired locations (options available up to 1gbps)

Room 313 (588 sq ft)

- 50 theater style, 22 u-shape, 30 classroom, 50 seated
- Installed AV: media podium, screen and projector

Room 314 (615 sq ft)

- 50 theater style, 22 u-shape, 30 classroom, 50 seated
- Installed AV: media podium, screen and projector

Room 315 (210 sq ft)

- Built-in work stations

MEETING ROOMS / Floor 4

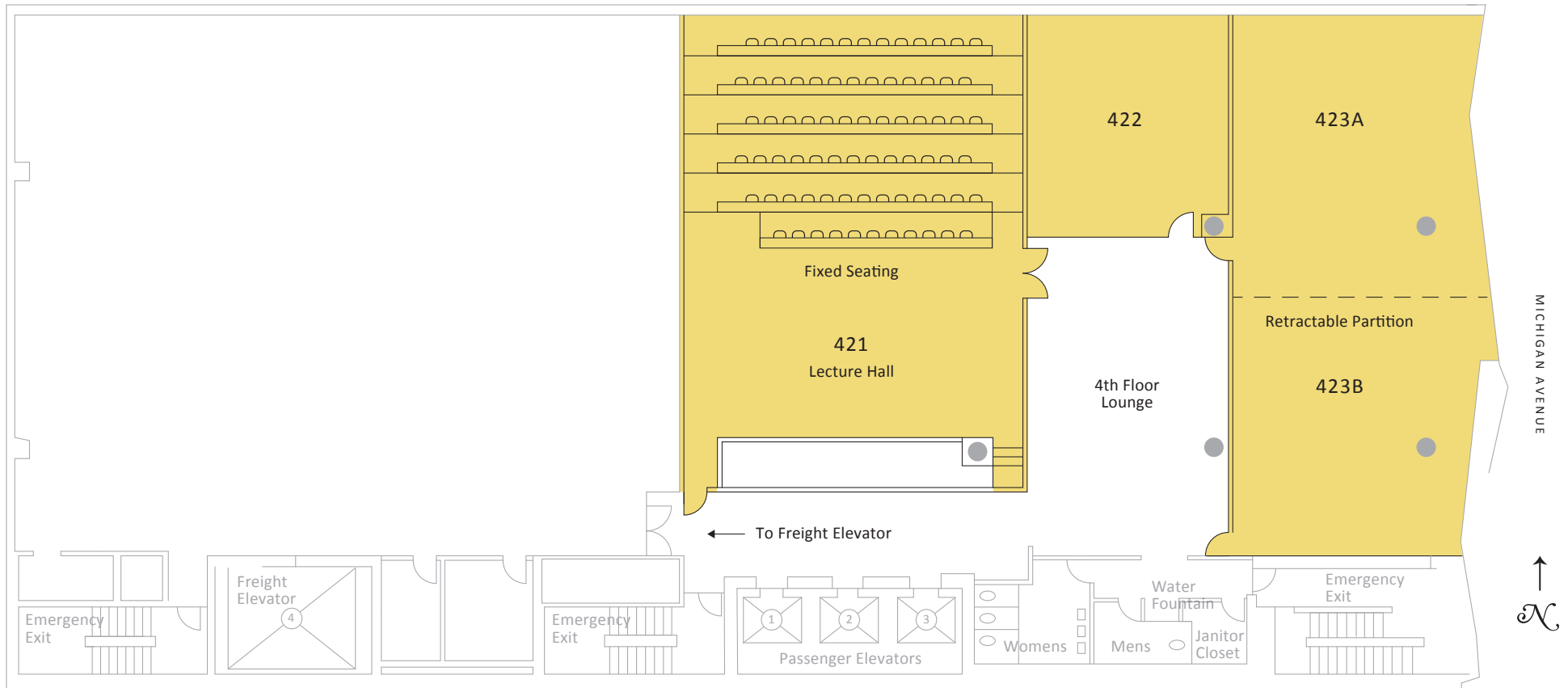

SPECIFICATIONS

All Spaces

- F&B allowed
- 10 ft ceilings
- Restrooms
- Wireless internet
- Wired locations (options available up to 1gbps)
- Installed AV: media podium, screen and projector

Lecture Hall 421 (1938 sq ft)

- 104 classroom style
- ### Room 422 (609 sq ft)
- 50 theater, 20 u-shape, 28 classroom, 40 seated

Room 423A (928 sq ft)

- 72 theater, 28 u-shape, 32 classroom, 60 seated
- Air-wall

Room 423B (822 sq ft)

- 72 theater, 28 u-shape, 32 classroom, 60 seated
- Air-wall

MEETING ROOMS / Floor 7

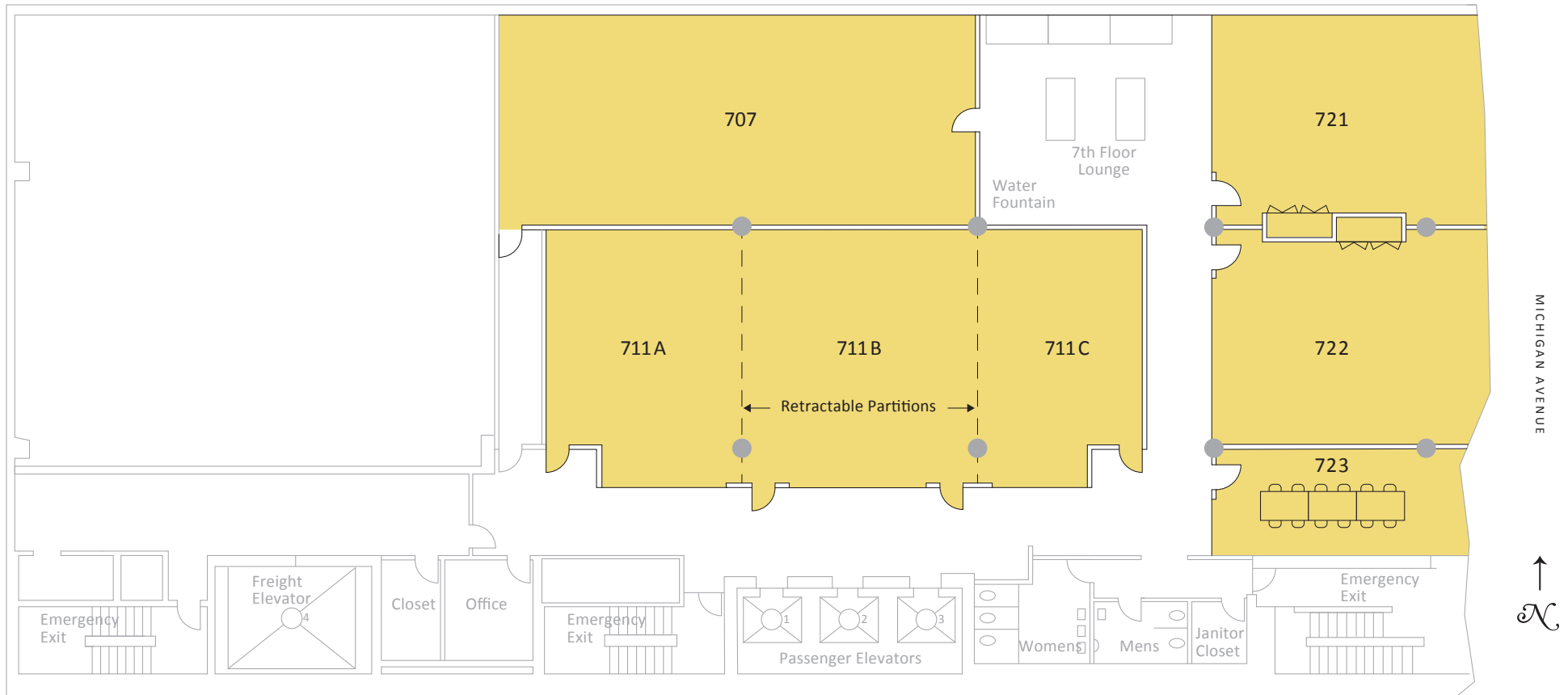

SPECIFICATIONS

All Spaces (unless indicated)

- F&B allowed
- 10 ft ceilings
- Restrooms
- Wireless internet
- Wired locations (options available up to 1gbps)
- Installed AV: media podium, screen and projector

Room 707 (1380 sq ft)

- 130 theater, 34 u-shape, 68 classroom, 100 seated
- Installed AV: media podium, Screen and Projector x 2

Room 711A (618 sq ft)

- 50 theater, 20 u-shape, 28 classroom, 40 seated
- Air-wall

Room 711B (793 sq ft)

- 60 theater, 28 u-shape, 36 classroom, 50 seated
- Air-wall

Room 711C (543 sq ft)

- 40 theater, 20 u-shape, 24 classroom, 40 seated
- Air-wall

Room 721 (638 sq ft)

- 50 theater, 22 u-shape, 30 classroom, 50 seated

Room 722 (653 sq ft)

- 50 theater, 22 u-shape, 30 classroom, 50 seated

Room 723 (354 sq ft)

- Boardroom seating 12
- No installed AV